

2020-2021
Academic Year



FACULTY OF ARCHITECTURE AND DESIGN
DEPARTMENT OF ARCHITECTURE

1. Contents	3
2. Preface	4
3. History of Özyeğin University and Faculty of Architecture & Design	5
4. General Information	6
5. Department of Architecture	12
6. Undergraduate Programs	13
7. Post-Graduate Programs	17
8. International	21
9. Department Comissions and Committees	24
10. Studio Culture	25
11. Internship	28
12. Information about Academic Building 4	29

2. Preface

The most basic requirement of human beings to sustain their lives in comfortable, convenient, aesthetically high level and secure-safe habitat and living environments with products which have the same features, besides the health and justice requirements. This requirement is one of the basic tasks of the provision of professional groups that make up the environment.

Architects and designers are leaders and pioneers in the groups of teams who are responsible for creation of conditions that contribute to the formation of the cities, buildings, spaces, products and environments that meet the needs of human being and society. Faculty of Architecture and Design at Özyeğin University, aims to educate creative architects and designers who understand the importance of integrated design, technology, innovation and entrepreneurship with a special focus on sustainable design in education, research and professional studies.

Prof. Dr. Aslıhan Ünlü
Dean



3. History of Özyeğin University and Faculty of Architecture & Design

Ozyegin University Faculty of Architecture and Design was established in April 2012 with the Department of Architecture which had first 60 students in 2012-2013 Academic year. Industrial Design; Communication Design; Interior Architecture and Environmental Design departments were established and had first students in 2013-2014 academic year. Faculty of Architecture and Design today had approximately 1150 undergraduate students in these for departments.

MSc in Architecture and MSc and PhD in Design, Technology and Society post-graduate programs started to have students in 2014-2015 academic year. PhD in Architecture Program, and MSc in City and Architecture program (in Turkish) started to have new students in 2020-2021 academic year fall term.

Vision:

Being among the best schools in terms of education and research in national, regional and global levels; having top level creative, innovative graduates who will contribute to the welfare of the people at the national, regional and global levels.

Mission:

is to address to improve the sustainability of local regional and global values by using creativity, innovation and entrepreneurship approaches in education, research and practice; to focus on integrated design and manufacturing axis in all programs by using effective interaction with related sectors and potentials of Istanbul; and having graduates who will able to apply these values.

The priority of Faculty of Architecture & Design in education, research and implementation; is focusing on entrepreneurship and innovation that are based on the axis of design within the context of sustainable and interaction design to conserve the local and global resources.

Faculty of Architecture and Design web site:

<https://www.ozyegin.edu.tr/en/faculty-architecture-and-design>

4. General Information

The departments of Faculty of Architecture and Design

Architecture (Undergraduate Program in Turkish / Undergraduate Program in English)

<https://www.ozyegin.edu.tr/en/architecture>

Industrial Design (Undergraduate program in English)

<https://www.ozyegin.edu.tr/en/industrial-design>

Communication Design (Undergraduate program in English)

<https://www.ozyegin.edu.tr/en/communication-design>

Interior Architecture and Environmental Design (Undergraduate program in English)

<https://www.ozyegin.edu.tr/en/interior-architecture-and-environmental-design>

The post-graduate programs of Faculty of Architecture and Design

MSc in Architecture (Thesis/Non-thesis) (Master program in English)

<https://www.ozyegin.edu.tr/en/faculty-architecture-and-design/graduate-programs>

MSc in Design, Technology and Society (Thesis/Non-thesis) (Master program in English)

<https://www.ozyegin.edu.tr/en/design-technology-and-society-masters-degree-program-thesis>

MSc in City and Architecture (Thesis/Non-thesis) (Master program in Turkish)

<https://www.ozyegin.edu.tr/en/faculty-architecture-and-design/graduate-programs>

PhD in Design, Technology and Society (Doctorate program in English)

<https://www.ozyegin.edu.tr/en/design-technology-and-society-phd-program>

PhD in Architecture (Doctorate program in English)

<https://www.ozyegin.edu.tr/en/faculty-architecture-and-design/graduate-programs>

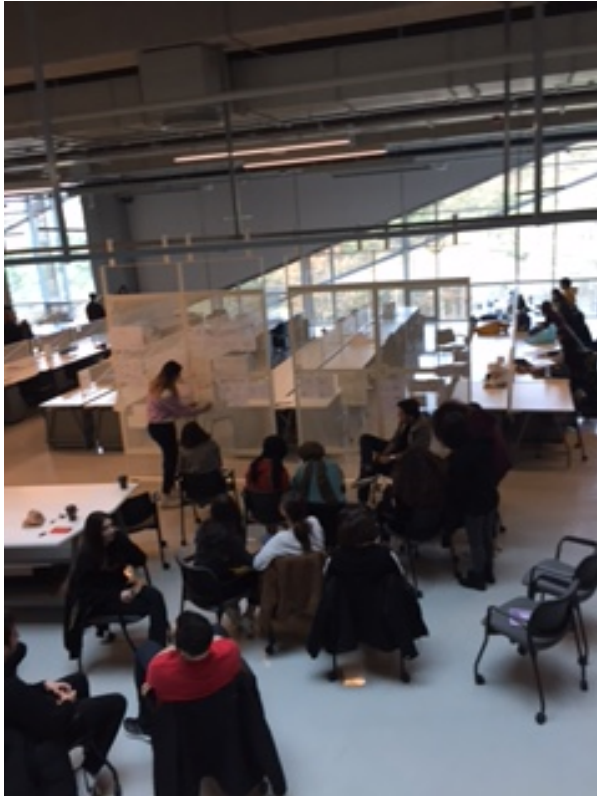

Laboratories and Workshops of Faculty of Architecture and Design

Computer Laboratory: Computer laboratory serves for computer aided design courses with its 30 PCs and related software programs.

MAC Lab: The laboratory serves with 20 IMac computers and related software for graphic design, game design, animation, video making subjects and the courses on these subjects.

Model Workshop: Model workshop give opportunity to make models by students for their individual or team studies related with their different courses. a 3 D CNC Router, a vacuum forming machine, a circular saw, a vertical saw, a jigsaw, a hotwire saw, a column drill, and a lathe. A painting room serves in the model workshop.

Digital Model Workshop: Digital Model Workshop has a 3 D printer, a laser cutter and other tools for digital models and maker studies. An electronics workshop also open to use for the students.

Design and Build Workshop: Design and Build Workshop serves to make mock-ups and / or prototypes of building components and furniture designed by students and faculty in studios. It had two laser cutters.

Ceramic Workshop: Ceramic Workshop designed to serve work on ceramics, pottery, sculpture and producing other ceramic products. It had pottery tourniquets, pottery countertop machines, ceramic furnace.

Research Groups / Laboratories

URBAN & HOUSING LAB



It is aimed to reflect and allow current information and technological development that respond to interdisciplinary research, application and in-house requirements at national and international level based on sustainability, community benefit and environmental awareness. In this context Urban and Housing Research Laboratory:

- Supporting education and training,
- Organizing national and international meetings,
- Organizing national and international short-term courses,
- Publish all types of research outputs,

In the laboratory, urban and housing research will be carried out in a multidisciplinary manner. It will be ensured that the widespread experience of laboratory, the development of research within interaction of public and private sector and transferring it to the field of application. The Urban and Housing Laboratory works together with IAPS Culture and Space Network.

IAPS CS NETWORK Prof. (PhD) Hülya Turgut (Network Coordinator)

(hulya.turgut@ozyegin.edu.tr) , Prof.(PhD) Orhan Hacıhasanoğlu (Network founder

member) (orhan.hacihasanoglu@ozyegin.edu.tr), Prof. (PhD) Alper Ünlü (Network founder

member) (alper.unlu@ozyegin.edu.tr)

IAPS Culture and Space Network was established in 1997 as one of the networks of IAPS (International Association for People Environment Studies). IAPS CS Network organizes international and national symposiums, national workshops, and publish books, selected articles dossiers and special dossiers in journals



URL

<http://iaps-association.org/networks/culture-and-space/>

<https://www.facebook.com/IapsCsNetwork>

<http://www.iaps-culturespace.org/>

Urban and Housing Lab Director: Prof. Hülya Turgut (PhD),

(hulya.turgut@ozyegin.edu.tr) URL: <http://labs.ozyegin.edu.tr/urbanandhousing/>

SPATIAL SYSTEMS RESEARCH LABORATORY



Spatial Systems Research Laboratory is the laboratory where the analyzes of architectural and urban spaces are carried out with the help of Space Syntax.



Measurement of the Relationship Between Space Fiction and User Behavior: User-Oriented Approaches to Urban Square Arrangements in Suburban District Municipalities of Istanbul - Research Project Senior Lecturer (PhD) Ayşe Özbil Torun (Spatial Systems Research Lab Founder – Northumbria University - ayse.torun@northumbria.ac.uk),

Spatial Systems Lab Director: Prof. Alper Ünlü (PhD)

(alper.unlu@ozyegin.edu.tr), URL: <http://labs.ozyegin.edu.tr/spatialsystems/>

DYNAMIC RESEARCH ON URBAN MORPHOLOGY LAB



The DRUM (Dynamic Research on Urban Morphology) research group focuses on the diachronic aspect of urban and territorial transformations; it welcomes the expertise of Architects, Urban Planners, and Urban Morphologists including broad interdisciplinary cooperation with other disciplines such as Geography, History and Archaeology.

The research group aims to describe the dynamics of urban growth in different morphological and geographical settings by comparing a number of relevant case studies in capital cities. The research group applies the comparative method and other analytic tools, such as GIS, Space Syntax, Typological plans, Conzenian analysis at different scales and within different chronological phases to understand the past and above all, to design the future of large cities. Director of DRUM Lab Assoc. Prof. Alessandro Camiz (alessandro.camiz@ozyegin.edu.tr), URL: <http://labs.ozyegin.edu.tr/drum/>

VIRTUAL REALITY (VR) LABORATORY



Virtual Reality (VR) is a laboratory equipped with the infrastructure and equipment suitable for conducting research, experiments and applications of virtual reality applications. Virtual Reality Lab Director: Instructor Can Bora Sezer (bora.sezer@ozyegin.edu.tr)

URL: <http://vr.ozyegin.edu.tr/>

MEDIA LABORATORY



The Media Laboratory provides a suitable environment and equipment for research, student studies and lectures on photography, video, documentary cinema, film. Media Lab Director: Assistant Prof. Metin Çavuş (PhD) (metin.cavus@ozyegin.edu.tr)

URL: <http://labs.ozyegin.edu.tr/medialab/>

USER EXPERIENCE (UX) LABORATORY

It is the laboratory where user experience and interaction experience are carried out. User Experience (UX) Lab Director: Assistant Prof. Zeynep Karapars (PhD) (zeynep.karapars@ozyegin.edu.tr) URL:



BUILDING PHYSICS AND MATERIALS LABORATORY



The Building Materials and Physics Laboratory of the Faculty of Architecture and Design of Özyeğin University is aimed to carry out the research studies in the field of “Building Science”. It is also intended to constitute a platform which is either giving related lectures at the undergraduate and graduate levels or providing consultancy to the private and public sector. The research area of the laboratory can be summarized as:

- Building Energy Systems
 - Energy Efficient Building Design and Renovation
 - Nearly Zero/Zero Energy Building Design and Renovation
 - Energy-Cost Analyses
 - Renewable Energy Systems
 - Climate Change Adaptation
 - Cost Optimum Energy Efficient Building Design and Renovation
 - Building energy performance modelling and detailed dynamic simulations
 - Consultancy and Energy Modelling Servicing for Various Building Certificate Systems (LEED, BREEAM, ÇEDBİK etc.)
- Sustainable Architectural Design
 - Green Building Design
 - Building Materials
 - Ecological Architecture
 - Lifecycle Analyses
 - Indoor Environment Quality (IEQ)
 - Occupancy Comfort
- Lighting in Buildings
 - Natural and Artificial Lighting Systems
 - Lighting Energy Efficiency
 - Visual Comfort
- Building Acoustics
- Energy Efficiency at Urban Scale
 - Energy efficiency at Smart Cities
 - Heat Islands
 - Energy-efficient Site Design

Building Physics and Materials Lab Coordinators: Assistant Prof. Touraj Ashrafiyan (PhD) (touraj.ashrafiyan@ozyegin.edu.tr); Assistant Prof. (PhD) Neşe Ganiç Sağlam (nese.saglam@ozyegin.edu.tr): Assistant Prof. (PhD) (ece.kalaycioglu@ozyegin.edu.tr).
URL: <http://labs.ozyegin.edu.tr/bmplab/>

LANDSCAPE RESEARCH LABORATORY



The Landscape Research Lab (LRL) at ÖzÜ produces theoretical and applied research platform that facilitates the design for all manner of sustainable landscape at the urban and rural environment. LRL handles the determination of landscape characteristics, landscape

components and elements in a holistic way. Natural, semi natural or totally manmade characteristics of landscape are the subjects of the research for future developments to promote healthy communities and challenge epistemological capacities of the subject area. Thus, LRL aims to work collaboratively to search the contemporary strategies on the relationships between natural environment and the specificities of built infrastructure via education, interdisciplinary research, and innovation for the following areas and their sub themes: Resilient Cities, Green&Blue Infrastructure, Disaster Risk Reduction, Landscape Ecology, Landscape Heritage.

LRL Lab researchers: Assitant Prof.(PhD) Beyza Şat Güngör, (beyza.gungor@ozyegin.edu.tr); Assistant Prof. (PhD) Doğa Dinemis Aman (dinemis.aman@ozyegin.edu.tr); LRL Director: Assistant Prof. (PhD) Beyza Şat Güngör (beyza.gungor@ozyegin.edu.tr); URL: <http://labs.ozyegin.edu.tr/lrl/>

ARCHITECTURAL DESIGN RESEARCH LABORATORY



Architectural Design Research Laboratory is a platform that produces theoretical and practical knowledge through design and contributes to the design of qualified living environments. The main objectives of the laboratory are to create sharing and production environments such as seminars, workshops that bring together different actors of the architectural design environment and to develop research projects focused on architectural design. The laboratory also aims to allow students to experience the different stages and roles of the research and design process and, in this direction, cooperates with the architectural design office simulator (MITOS). Architectural Design Rezearch Laboratory Director: İlker Özorhon (PhD) (ilker.ozorhon@ozyegin.edu.tr) Lab email: adrlab@ozyegin.edu.tr URL: <http://labs.ozyegin.edu.tr/adr/>



5. Department of Architecture

Department Head:

Assoc. Prof. Murat Şahin (PhD)

Faculty:

Assistant Prof. Doğa Dinemis Aman (PhD)

Assistant Prof. Touraj Ashrafian (PhD)

Assoc. Prof. Alessandro Camiz (PhD)

Assistant Prof. Nevşet Gül Çanakçıoğlu (PhD)

Assistant Prof. Neşe Ganiç Sağlam (PhD)

Assistant Prof. Ayşe Ceren Güler (PhD)

Instructor Cansu Günaydın

Assistant Prof. Tayfun Gürkaş (PhD)

Prof. Orhan Hacıhasanoğlu (PhD)

Assistant Prof. Ece Kalaycıoğlu Özdemir (PhD)

Instructor Ömer Karadağ

Assistant Prof. Ebru Karahan (PhD)

Assistant Prof. Demet Mutman (PhD)

Assistant Prof. Luca Orlandi (PhD)

Assistant Prof. Kaan Özgün (PhD)

Assoc. Prof. Güliz Özorhon (PhD)

Assistant Prof. İlker Fatih Özorhon (PhD)

Assoc. Prof. Murat Şahin (PhD)

Assistant Prof. Melis Taner (PhD)

Assistant Prof. Semra Tokay (PhD)

Prof. Hülya Turgut (PhD)

Prof. Alper Ünlü (PhD)

Prof. Aslıhan Ünlü (PhD)

Assistant Prof. Derya Yorgancıoğlu (PhD)

Research Assistants:

Res. Assistant İrem Bayraktar

Res. Assistant Gizem Efendioğlu

Res. Assistant Gülbin Lekesiz

Res. Assistant Dilara Nitelik

Res. Assistant Özge Özkuvancı

Res. Assistant Göksu Sarman

Res. Assistant Hande Tunç

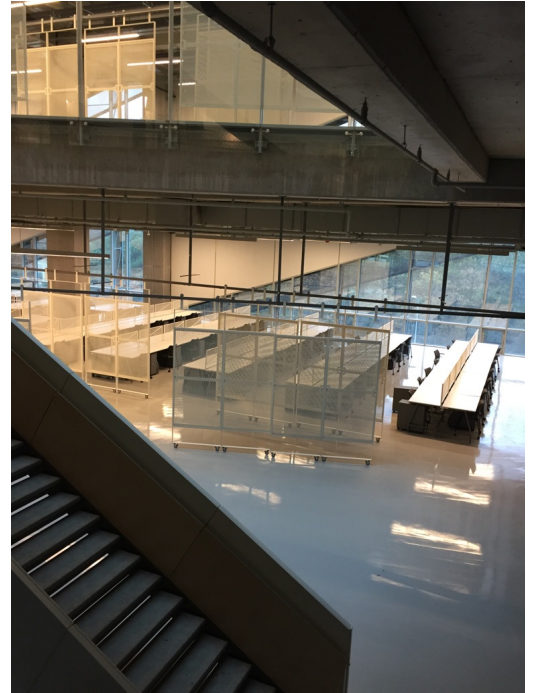

6. Undergraduate Programs

Özyeğin University Faculty of Architecture and Design, Department of Architecture

BS ARCHITECTURE

CURRICULUM 2020-2021 ACADEMIC YEAR

CODE	TITLE	CREDITS	PREREQUISITE	COREQUISITE	SEMESTER
ARCH 101	Design	8			1. Year - Fall
ARCH 103	Architectural Representation Techniques I	4			1. Year - Fall
ARCH 105	Culture of Architecture	4			1. Year - Fall
ENG 101	English I	4			1. Year - Fall
MATH 101	Mathematics for Social Sciences I	6			1. Year - Fall
TLL 101	Turkish Language and Literature I	4			1. Year - Fall
ARCH 102	Architectural Design Studio I	10	ARCH 101		1. Year - Spring
ARCH 104	Architectural Representation Techniques II	4			1. Year - Spring
ARCH 106	Space Planning	4			1. Year - Spring
ARCH 108	History of Art	4			1. Year - Spring
ENG 102	English II	3	ENG 101		1. Year - Spring
SEC 101	Introduction to University	1			1. Year - Spring
TLL 102	Turkish Language and Literature II	4			1. Year - Spring
ARCH 200	Summer Internship I (Research)	2			2. Year - Fall
ARCH 201	Architectural Design Studio II	10	ARCH 102		2. Year - Fall
ARCH 203	Computer Aided Design I	4			2. Year - Fall
ARCH 205	Building Construction and Materials	5			2. Year - Fall
ARCH 207	Statics and Mechanics of Materials	4			2. Year - Fall
ARCH 209	History of Architecture I	3			2. Year - Fall
SEC 201	Introduction to Sectors	2	To complete at least 45 ECTS		2. Year - Fall
ARCH 202	Architectural Design Studio III	10	ARCH 201		2. Year - Spring
ARCH 204	Computer Aided Design II	4			2. Year - Spring
ARCH 206	Construction Technologies	4			2. Year - Spring
ARCH 208	Structural Analysis	4	ARCH 207		2. Year - Spring
ARCH 210	History of Architecture II	3			2. Year - Spring
ARCH 212	Site Analysis and Sustainable Landscape Design	3			2. Year - Spring
SEC 202	Skills Management	2	To complete 45 ECTS and pass from SEC 201		2. Year - Spring
ARCH 300	Summer Internship II (Office)	2	SEC 201 and SEC 202		3. Year - Fall
ARCH 301	Architectural Design Studio IV	10	ARCH 202		3. Year - Fall
ARCH 303	Urban Planning and Design	4			3. Year - Fall
ARCH 305	Environmental Control	4			3. Year - Fall
HIST 201	Principles of Ataturk and History of the Turkish Republic I	4			3. Year - Fall
	BSARCH (EN) - Program Elective Courses	3			3. Year - Fall
	BSARCH (EN) - Program Elective Courses	3			3. Year - Fall
ARCH 302	Architectural Design Studio V	10	ARCH 301		3. Year - Spring
ARCH 304	Architectural Conservation and Surveying	6			3. Year - Spring
ARCH 306	Building Systems	4			3. Year - Spring
HIST 202	Principles of Ataturk and History of the Turkish Republic II	4	HIST 201		3. Year - Spring
	BSARCH (EN) - Program Elective Courses	3			3. Year - Spring
	BSARCH (EN) - Program Elective Courses	3			3. Year - Spring
ARCH 400	Summer Internship III (Construction Site)	4	SEC 201 and SEC 202		4. Year - Fall
ARCH 401	Architectural Design Studio VI	12	ARCH 302		4. Year - Fall
ARCH 403	Construction Management and Economics	4			4. Year - Fall
ARCH 405	Professional Law	4			4. Year - Fall
	BSARCH (EN) - Non-Faculty Elective Courses	3			4. Year - Fall
	BSARCH (EN) - Program Elective Courses	3			4. Year - Fall
ARCH 402	Graduation Project	14	ARCH 401		4. Year - Spring
ARCH 404	Project Management	4			4. Year - Spring
	BSARCH (EN) - Non-Faculty Elective Courses	3			4. Year - Spring
	BSARCH (EN) - Program Elective Courses	3			4. Year - Spring
	BSARCH (EN) - Program Elective Courses	3			4. Year - Spring
	BSARCH (EN) - Program Elective Courses	3			4. Year - Spring

Özyeğin University Faculty of Architecture and Design, Department of Architecture
ELECTIVE COURSES

- ARCH 313_Model Making and Modelling (3 ECTS)
ARCH 318_New Building in Existing Pattern and Re-use (3 ECTS)
ARCH 321_Architecture and Mobility (3 ECTS)
ARCH 420_İstanbul (3 ECTS)
ARCH 423_Sustainable Design and Environment through Biomimicry (3 ECTS)
ARCH 424_Green Building and Sustainable Design (3 ECTS)
ARCH 425_Spatial Design (3 ECTS)
ARCH 427_Design Research for Deciphering the Place (3 ECTS)
ARCH 431_Body and Space in Architecture (3 ECTS)
ARCH 432_Plant Material (3 ECTS)
ARCH 433_Architecture, Cities and Cinema (3 ECTS)
ARCH 434_Parametric Design (3 ECTS)
ARCH 438_Re-reading the City through Critical Mapping (3 ECTS)
ARCH 439_Society, Space, Current Dynamics and the Public Realm (3 ECTS)
ARCH 440_Spatial Perception and Cognition (3 ECTS)
ARCH 441_Algorithm Aided Architectural Design (3 ECTS)
ARCH 442_Industrial Heritage Conservation and Reuse (3 ECTS)
ARCH 444_Introduction to Islamic Art (3 ECTS)
ARCH 445_Islamic Architecture (3 ECTS)
ARCH 446_Architectural Regeneration and Reuse (3 ECTS)
ARCH 448_Library Design (3 ECTS)
ARCH 449_Airport Design (3 ECTS)
ARCH 451_City, Landscape and Form (3 ECTS)
ARCH 452_Urban Morphology (3 ECTS)
ARCH 453_Theories and Critics in Architecture after Modernism (3 ECTS)
ARCH 455_Building Modelling Techniques (3 ECTS)
ARCH 456_Culture and Space: Home (3 ECTS)
ARCH 457_RobArt (4 ECTS)
ARCH 458_Design Fabrication (4 ECTS)
ARCH 460_Global Studies in Architecture and Design (3 ECTS)

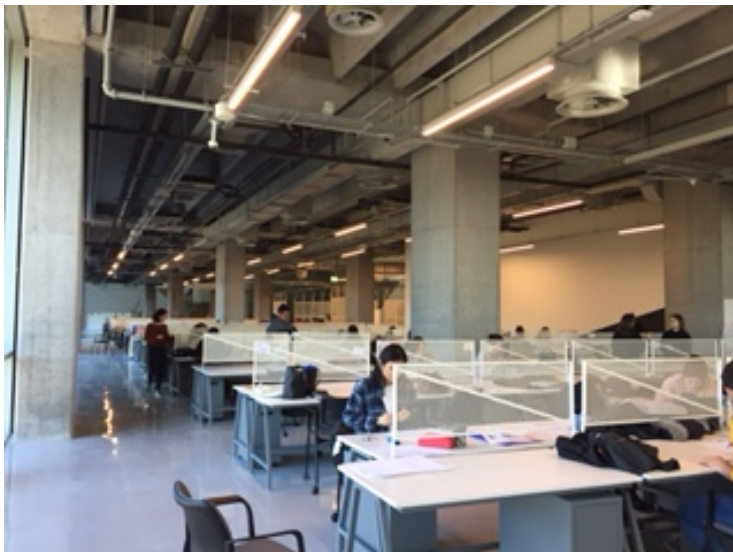

Özyeğin University Faculty of Architecture and Design, Department of Architecture
BS ARCHITECTURE (Turkish section)
CURRICULUM 2020-2021 ACADEMIC YEAR

CODE	TITLE	CREDITS	PREREQUISITE	COREQUISITE	SEMESTER
ENG 103	İngilizce I (Türkçe Programlar)	4			1. Year - Fall
MATH 107	Sosyal Bilimler için Matematik I	6			1. Year - Fall
MİM 101	Tasarım	8			1. Year - Fall
MİM 103	Mimarî Anlatım Teknikleri I	4			1. Year - Fall
MİM 105	Mimarlık Kültürü	4			1. Year - Fall
TLL 101	Türk Dili ve Edebiyatı I	4			1. Year - Fall
ENG 104	İngilizce II (Türkçe Programlar)	3	ENG 103 or ENG 101		1. Year - Spring
MİM 102	Mimarî Tasarım Stüdyosu I	10	MİM 101 or ARCH 101		1. Year - Spring
MİM 104	Mimarî Anlatım Teknikleri II	4			1. Year - Spring
MİM 106	Mekan Organizasyonu	4			1. Year - Spring
MİM 108	Sanat Tarihi	4			1. Year - Spring
SEC 101	Üniversite Yaşamına Giriş	1			1. Year - Spring
TLL 102	Türk Dili ve Edebiyatı II	4			1. Year - Spring
MİM 201	Mimarî Tasarım Stüdyosu II	10	MİM 102 or ARCH 102		2. Year - Fall
MİM 203	Bilgisayar Destekli Tasarım I	4			2. Year - Fall
MİM 205	Yapı Bilgisi ve Malzeme	5			2. Year - Fall
MİM 207	Statik ve Mukavemet	4			2. Year - Fall
MİM 209	Mimarlık Tarihi I	3			2. Year - Fall
SEC 203	Sektörlere Giriş	2	At least 45 ECTS completed		2. Year - Fall
MİM 200	BSARCH (TR) – Yaz stajı I (Araştırma)	2			2. Year - Fall
MİM 202	Mimarî Tasarım Stüdyosu III	10	MİM 201 or ARCH 201		2. Year - Spring
MİM 204	Bilgisayar Destekli Tasarım II	4			2. Year - Spring
MİM 206	Yapı Teknolojileri	4			2. Year - Spring
MİM 208	Yapı Statığı	4	MİM 207 or ARCH 207		2. Year - Spring
MİM 210	Mimarlık Tarihi II	3			2. Year - Spring
MİM 212	Çevre Analizi ve Sürdürülebilir Peyzaj Tasarımı	3			2. Year - Spring
SEC 204	Yetkinlik Yönetimi	2	At least 45 ECTS completed and SEC 101		2. Year - Spring
HIST 201	Atatürk İlkeleri ve İnkılap Tarihi I	4			3. Year - Fall
MİM 301	Mimarî Tasarım Stüdyosu IV	10	MİM 202		3. Year - Fall
MİM 303	Kentsel Planlama ve Tasarım	4			3. Year - Fall
MİM 305	Fiziksel Çevre Kontrolü	4			3. Year - Fall
	BSARCH (TR) - Program Elective	3			3. Year - Fall
	BSARCH (TR) - Program Elective	3			3. Year - Fall
MİM 300	BSARCH (TR) – Yaz Stajı II (Büro)	2	SEC 203 and SEC 204		3. Year - Fall
HIST 202	Atatürk İlkeleri ve İnkılap Tarihi II	4	HIST 201		3. Year - Spring
MİM 302	Mimarî Tasarım Stüdyosu V	10	MİM 301 or ARCH 301		3. Year - Spring
MİM 304	Mimarî Koruma ve Rölöve	6			3. Year - Spring
MİM 306	Yapı Sistemleri	4			3. Year - Spring
	BSARCH (TR) - Program Elective	3			3. Year - Spring
	BSARCH (TR) - Program Elective	3			3. Year - Spring
MİM 401	Mimarî Tasarım Stüdyosu VI	12	MİM 302		4. Year - Fall
MİM 403	Yapım Yönetimi ve Ekonomisi	4			4. Year - Fall
MİM 405	Meslek Hukuku	4			4. Year - Fall
	BSARCH (TR) – Non-Faculty Elective	3			4. Year - Fall
	BSARCH (TR) – Program Elective	3			4. Year - Fall
MİM 400	BSARCH (TR) – Yaz Stajı III (Şantiye)	4	SEC 203 and SEC 204		4. Year - Fall
MİM 402	Mezuniyet Projesi	14	MİM 401 or ARCH 401		4. Year - Spring
MİM 404	Proje Yönetimi	4			4. Year - Spring
	BSARCH (TR) – Non-Faculty Elective	3			4. Year - Spring
	BSARCH (TR) - Program Elective	3			4. Year - Spring
	BSARCH (TR) - Program Elective	3			4. Year - Spring
	BSARCH (TR) - Program elective	3			4. Year - Spring

Özyeğin University Faculty of Architecture and Design, Department of Architecture
ELECTIVE COURSES

- MİM 313_Maket Yapımı ve Modelaj (3 AKTS)
MİM 314_Mimarlıkta Fotoğraf (3 AKTS)
MİM 315_Mimaride Ulaşılabilirlik (3 AKTS)
MİM 317_Geleneksel Mimarlık (3 AKTS)
MİM 318_Mevcut Doku İçinde Yeni Yapı ve Yeniden Kullanım (3 AKTS)
MİM 320_Birey, Toplum ve Tekno-bilişimsel Mekanlar (3 AKTS)
MİM 322_Ütopyalar-Distopyalar, Ütopik Kentler ve Mimarlıkta Ütopya (3 AKTS)
MİM 323_Çocuk, Mimarlık ve Kent (3 AKTS)
MİM 324_Modernleşme Dönemi Türkiye Mimarlığı (3 AKTS)
MİM 325_Mimarlıkta Kavramsallaştırma (3 AKTS)
MİM 413_Konut Tasarım ve Üretim Modelleri (3 AKTS)
MİM 420_İstanbul (3 AKTS)
MİM 422_Mimarlığa Disiplinlerarası Yaklaşımlar (3 AKTS)
MİM 423_Biomimesis ile Sürdürülebilir Tasarım ve Çevre (3 AKTS)
MİM 424_Yeşil Binalar ve Sürdürülebilir Tasarım (3 AKTS)
MİM 425_Mekansal Tasarım (3 AKTS)
MİM 429_Müze ve Mimarlık (3 AKTS)
MİM 431_Mimarlıkta Beden ve Mekan (3 AKTS)
MİM 434_Parametrik Tasarım (3 AKTS)
MİM 436_Mimari Tasarımda Yer, Kavram ve Bağlam
MİM 441_Algoritma Destekli Mimari Tasarım (3 AKTS)
MİM 442_Endüstri Mirası Koruma ve Yeniden Kullanma (3 AKTS)
MİM 443_Kamusal Alan, Birey ve Şehir Kültürü (3 AKTS)
MİM 447_Tarih İçinde Kentler (3 AKTS)
MİM 448_Kütüphane Tasarımı (3 AKTS)
MİM 449_Havaalanı Tasarımı (3 AKTS)
MİM 450_Tiyatro, Sahne Mekanları ve Mimarlık (3 AKTS)
MİM 454_Toplumsal Hafıza Mekanları ve Mimarlık (3 AKTS)



7. Post-Graduate Programs

MSc in Architecture (Thesis-Nonthesis) Program (English)

MSc Architecture (Thesis) Program Curriculum / Conditions for Graduation

3 compulsory courses, 4 elective courses, a seminar course and a thesis should be taken and passed for graduation. In order to graduate from the program, a total of 120 ECTS credits must be completed successfully. Students have the opportunity to take elective courses from other programs.

<https://www.ozyegin.edu.tr/en/faculty-architecture-and-design/graduate-programs/msc-architecture-thesis-program>

MSc in Architecture (Thesis) Program	
1. Term	2. Term
ARCH 501 Research Methods - (7,5 ECTS)	ARCH 502 Project - (7,5 ECTS)
ARCH 503 Theory Of Architecture - (7,5 ECTS)	ARCH 590 Seminar - (7,5 ECTS)
ELECTIVE 1 - (7,5 ECTS)	ARCH 594 Master Thesis Study I In Architecture (7,5 ECTS)
ELECTIVE 2 - (7,5 ECTS)	ELECTIVE 3 - (7,5 ECTS)
1. Term Total: 30 ECTS	2. Term Total: 30 ECTS
3. Term	4. Term
ARCH 595 Master Thesis Study Ii In Architecture (22,5 ECTS)	ARCH 596 Master Degree Thesis In Architecture (30 ECTS)
SEÇME DERS 4 - (7,5 ECTS)	
3. Term Total: 30 ECTS	4. Term Total: 30 ECTS
MSC IN ARCHITECTURE (THESIS) PROGRAM	
TOTAL : 120 ECTS	

MSc Architecture (non-thesis) Program Curriculum / Conditions for Graduation

4 compulsory courses, 6 elective courses, a seminar course and a term project should be taken and passed for graduation. The total credits for graduation are defined as 90 ECTS. Students have the opportunity to take elective courses from other programs.

<https://www.ozyegin.edu.tr/en/faculty-architecture-and-design/graduate-programs/msc-architecture-non-thesis-program>

MSc in Architecture (Non-thesis) Program	
1. Term	2. Term
ARCH 501 Research Methods - (7,5 ECTS)	ARCH 552 Architectural Design 2 - (7,5 ECTS)
ARCH 551 Architectural Design 1 - (7,5 ECTS)	ARCH 518 Project And Construction Management - (7,5 ECTS)
ELECTIVE 1 - (7,5 ECTS)	ELECTIVE 3 - (7,5 ECTS)
SEÇME DERS 2 - (7,5 ECTS)	ELECTIVE 4 - (7,5 ECTS)
1. Term total : 30 ECTS	2. Term Total: 30 ECTS
3. Term	
ELECTIVE 5 - (7,5 ECTS)	
ELECTIVE 6 - (7,5 ECTS)	
ARCH 597 Term Project In Architecture (15 ECTS)	
3. Term Total: 30 ECTS	
MSC IN ARCHITECTURE (NON-THESIS) PROGRAM	
TOTAL : 90 ECTS	

MSc in City and Architecture (Thesis-Nonthesis) Program (Turkish)

MSc in City and Architecture (Thesis) Program Curriculum / Conditions for Graduation

The program consists of 4 consecutive semesters. Compulsory and elective courses specified in the course plan should be taken and passed for graduation. In order to graduate from the program, a total of 120 ECTS credits must be completed successfully.

<https://www.ozyegin.edu.tr/en/faculty-architecture-and-design/graduate-programs/msc-city-and-architecture-thesis>

MSc in City and Architecture (Thesis) Program	
1.Term	2.Term
KMI 501 Research Methods and Ethics 7,5 ECTS	KMI 503 Advance Design Research LAB II 7,5 ECTS
KMI 502 Advanced Design Research LAB I 7,5 ECTS	KMI 594 Master Thesis Study in City and Architecture I 7,5 ECTS
ELECTIVE 1 7,5 ECTS	ELECTIVE 3 7,5 ECTS
ELECTIVE 2 7,5 ECTS	ELECTIVE 4 7,5 ECTS
1.TERM TOTAL: 30 ECTS	2. TERM TOTAL: 30 ECTS
Workshop / Short Atelier	Workshop / Short Atelier
Term Exhibition 1 (related with LAB 1)	Term Exhibition 2 (related with LAB II)
3. Term	4. Term
KMI 590 Seminar* 7,5 ECTS	KMI 596 Master Thesis Study in City and Architecture III 30 ECTS
KMI 595 Master Thesis Study in City and Architecture II 15 ECTS	
3. TERM TOTAL 30 ECTS	4. TERM TOTAL 30 ECTS
Workshops / Short Atelier Term Exhibition 3 Annual Article Selection **	
MSC IN CITY AND ARCHITECTURE (THESIS) PROGRAM: 120 ECTS	

MSc in City and Architecture (Non-Thesis) Program Curriculum / Conditions for Graduation

The program consists of 3 consecutive semesters. Compulsory and elective courses specified in the course plan should be taken and passed for graduation. In order to graduate from the program, a total of 90 ECTS credits must be completed successfully.

<https://www.ozyegin.edu.tr/en/faculty-architecture-and-design/graduate-programs/msc-city-and-architecture-non-thesis>

MSc in city and Architecture (Non-Thesis) Program	
1. Term	2. Term
KMI 551 Advanced Design Studio I 15 ECTS	KMI 552 Advanced Design Studio II 15 ECTS
KMI 553 Space 1 7,5 ECTS	KMI 554 Space 2 7,5 ECTS
SEÇME DERS 1 7,5 ECTS	ELECTIVE 2 7,5 ECTS
1. TERM TOTAL: 30 ECTS	2. TERM TOTAL: 30 ECTS
Workshop / Short Atelier	Workshop / Short Atelier
Term Exhibition / Book Chapter 1 Adv. Design Studio I – Related works	Term Exhibition / Book Chapter 2 Adv. Design Studio II – related works
3. Term	
KMI 557 Space 3 7,5 ECTS	
ELECTIVE 3 7,5 ECTS	
ELECTIVE 4 7,5 ECTS	
KMI 560 Term Project 7,5 ECTS	
3. TERM TOTAL: 30 ECTS	
Workshop / Short Atelier	

Term exhibition / Book Chapter 3 Adv. Design Studio III – related works
MSC CITY AND ARCHITECTURE (NON-THESIS) PROGRAM TOTAL: 90 ECTS

PhD in Architecture (Doctorate program in English)

<https://www.ozyegin.edu.tr/tr/mimarlik-ve-tasarim-fakultesi/lisansustu-programlar/mimarlik-doktora-programi>

Ph.D. Program in Architecture / Curriculum / Conditions for Graduation

For graduation, those starting with a master's degree must complete two compulsory courses, six elective courses, a PhD proficiency study, and a doctoral thesis. It is graduated with a total of 240 ECTS credits. For graduation, those starting with a bachelor's degree must complete two compulsory courses, fourteen elective courses, a PhD proficiency study, and a doctoral thesis. In order to graduate from the program, a total of 300 ECTS credits must be completed successfully.

Course Plan for the Candidates Starting Ph.D. Program in Architecture with a Master Diploma

First Year	
1. Term	2. Term
ARCH 601* Research and Ethics (7,5 ECTS)	ELECTIVE 4 (7,5 ECTS)
ELECTIVE 1 (7,5 ECTS)	ELECTIVE 5 (7,5 ECTS)
ELECTIVE 2 (7,5 ECTS)	ELECTIVE 6 (7,5 ECTS)
ELECTIVE 3 (7,5 ECTS)	ARCH 690 Research Seminar (7,5 ECTS)
Term Total 30 ECTS	Term Total 30 ECTS
Second Year	
3. Term	4. Term
ARCH 900* PhD Proficiency Study (30 ECTS)	ARCH 901* PhD Thesis Proposal (30 ECTS)
Term Total 30 ECTS	Term Total 30 ECTS
Third Year	
5. Term	6. Term
ARCH 902* PhD Thesis Study I (30 ECTS)	ARCH 903* PhD Thesis Study II (30 ECTS)
Term Total 30 ECTS	Term Total 30 ECTS
Fourth Year	
7. Term	8. Term
ARCH 904* PhD Thesis Study III (30 ECTS)	ARCH 905* PhD Dissertation Study (30 ECTS)
Term Total 30 ECTS	Term Total 30 ECTS
Ph.D. Program in Architecture with a Master Diploma TOTAL ECTS: 240	

Course Plan for the Candidates Starting Ph.D. Program in Architecture with an Undergraduate Diploma

First Year	
1. Term	2. Term
ARCH 601* Research and Ethics (7,5 ECTS)	ELECTIVE 4 (7,5 ECTS)
ELECTIVE 1 (7,5 ECTS)	ELECTIVE 5 (7,5 ECTS)
ELECTIVE 2 (7,5 ECTS)	ELECTIVE 6 (7,5 ECTS)
ELECTIVE 3 (7,5 ECTS)	ARCH 690 Research Seminar (7,5 ECTS)
Term Total 30 ECTS	Term Total 30 ECTS
Second Year	
3. Term	4. Term
ELECTIVE 7 (7,5 ECTS)	ELECTIVE 11 (7,5 ECTS)
ELECTIVE 8 (7,5 ECTS)	ELECTIVE 12 (7,5 ECTS)
ELECTIVE 9 (7,5 ECTS)	ELECTIVE 13 (7,5 ECTS)
ELECTIVE 10 (7,5 ECTS)	ELECTIVE 14 (7,5 ECTS)
Term Total 30 ECTS	Term Total 30 ECTS
Third Year	
5. Term	6. Term
ARCH 900* PhD Proficiency Study (30 ECTS)	ARCH 901* PhD Thesis Proposal (30 ECTS)
Term Total 30 ECTS	Term Total 30 ECTS
Fourth Year	
7. Term	8. Term
ARCH 902* PhD Thesis Study I (30 ECTS)	ARCH 903* PhD Thesis Study II (30 ECTS)
Term Total 30 ECTS	Term Total 30 ECTS
Fifth Year	
9. Term	10. Term
ARCH 904* PhD Thesis Study III (30 ECTS)	ARCH 905* PhD Dissertation Study (30 ECTS)
Term Total 30 ECTS	Term Total 30 ECTS
Ph.D. Program in Architecture with an Undergraduate Diploma TOTAL ECTS: 300 ECTS	

8. International

Faculty of Architecture and Design is the member of following international associations:

CUMULUS (International Association of Universities and Colleges of Art, Design and Media)



EAAE (European Association for Architectural Education).



WDO (World Design Organization)



Ico-D (International Council of Design)



International Students

Özyeğin University Faculty of Architecture and Design encourage prospective international students to apply undergraduate and graduate programs.

Please find the information about application of international students to undergraduate and graduate programs from the following link:

<http://www.ozyegin.edu.tr/en/ULUSLARARASI/Full-Time-International-Studen...>

International Exchange for Students and Staff

Faculty of Architecture and Design has international exchange opportunities covering Erasmus Exchange and Global Exchange.

Please find the exchange information and partner universities form the following link.

<http://www.ozyegin.edu.tr/en/ULUSLARARASI/Degisim/Ortak-Kurumlar>

For more info:

International Relations Coordinator of Faculty of Architecture and Design

Assoc. Prof (PhD) Murat Şahin (murat.sahin@ozyegin.edu.tr)

Coordinator Department of Architecture:

Assist. Prof (PhD) Demet Mutman (demet.mutman@ozyegin.edu.tr)

Assist..Prof. (PhD) Nevşet Gül Çanakçıoğlu (gul.canakcioglu@ozyegin.edu.tr)

PARTNER UNIVERSITIES

Austria:

FH Joanneum University of Applied Sciences (Graz) (ERASMUS)

China:

Tongji University (Shanghai) (GLOBAL EXCHANGE)

Croatia:

University of Split (Split) (ERASMUS)

Egypt:

The American University of Cairo (Cairo) (GLOBAL EXCHANGE)

France:

The Sustainable Design School (Nice) (GLOBAL EXCHANGE)

Greece:

University of Thessaly (Volos) (ERASMUS)

Ecclesiastical Academy of Athens (Nea Kifissia) (ERASMUS)

University of Ioannina (Ioannina) (ERASMUS)

Hungary:

University of Pecs (Pecs) (ERASMUS)

University of Debrecen (Debrecen) (ERASMUS)

Italy:

Università degli Studi della Campania "Luigi Vanvitelli (Naples) (ERASMUS)

Politecnico di Bari (Bari) (ERASMUS)

Free University Bozen-Bolzano (Bozen) (ERASMUS)

Sapienza - University di Roma (Rome) (ERASMUS)

Università degli Studi di Palermo (Palermo) (ERASMUS)

Università Mediterranea di Reggio Calabria (Calabria) (ERASMUS)

Politecnico di Torino (Torino) (ERASMUS)

University of Pisa (Pisa) (ERASMUS)

Università degli Studi "G. d'Annunzio" Chieti – Pescara (Pescara) (ERASMUS)

Politecnico di Milano (Milan) (ERASMUS)

Università Roma Tre (Rome) (ERASMUS)

Università degli Studi di Napoli Federico II (Naples) (ERASMUS)

Università degli Studi Genova (Genova) (ERASMUS)

Lithuania:

Vilnius College of Design (Vilnius) (ERASMUS)

Mexico:

Universidad de Monterrey (Monterrey) (GLOBAL EXCHANGE)

Poland:

Lodz University of Technology (Lodz) (ERASMUS)

Cracow University of Technology (Cracow) (ERASMUS)

Portugal:

Escola Superior Artística do Porto (Porto) (ERASMUS)

Escola Superior Artes e Design (Porto) (ERASMUS)

University of Porto (Porto) (ERASMUS)

Serbia:

University of Nis (Nis) (ERASMUS)

University of Novi Sad (Novi Sad) (ERASMUS)

Spain:

University of Cardenal Herrera (Vallencia) (ERASMUS)

Universidad de Sevilla (Sevilla) (ERASMUS)

Universidad de Zaragoza (Zaragoza) (ERASMUS)

South Korea:

Sejong University (Seoul) (GLOBAL EXCHANGE)

Kookmin University (Seoul) (GLOBAL EXCHANGE)

Switzerland:

University of Applied Sciences and Arts Western Switzerland (Swiss European Mobility Program) (SEMP)

Taiwan:

National Taiwan University of Science and Technology (Tapei) (GLOBAL EXCHANGE)



9. Department Comissions and Committees

Department Advisory Council:

Neslihan Aksoy, Melike Altınıřık, İbrahim Eyüp, Ozan Öztepe, Yavuz Selim Sepin,

Quality and Accreditation Comission:

Orhan Hacıhasanođlu, Hülya Turgut, Murat řahin, Güliz Özorhon, İlker Fatih Özorhon, Ebru Karahan, Nevřet Gül Çanakçiođlu, Derya Yorgancıođlu

Transfer Comission:

Demet Mutman, Melis Taner,

Internship Comission:

Semra Tokay, Ebru Karahan, Mehmet Saner, Tayfun Gürkař, Neře Ganiç Sađlam, Ece Kalaycıođlu Özdemir, Orhan Hacıhasanođlu,

International Relations Comission:

Murat řahin, Nevřet Gül Çanakçiođlu, Demet Mutman, Touraj Ashrafian Bonab, Luca Orlandi.

10. Studio Culture

ÖzÜ FAD Department of Architecture Studio Culture – 17th May 2021

Introduction:

OzÜ FAD Department of Architecture Studio Culture Document were created with their opinions on the studio Özyeğin University Faculty of Architecture and Design Dept., Department of Architecture Department, Academic Board of Architecture Department, Students of Architecture Department (Volunteer) Education Working Group members. Studio culture is sent to the stakeholders of the education at the beginning of each semester. The main aim of this study is to apply the " Studio Culture of ÖzÜ FAD Department of Architecture " in the design studios which constitute the backbone of the curriculum.

Curriculum – Program Outcomes – Learning Outcomes – Course Contents – Course Aims:

The design studios like many other architectural programs, start with "Tasarım / Design" and continue a series of studios as "Design Studio I-VI / Architectural Design Studio I-VI" and ending with "Mezuniyet Projesi /Capstone Project" each prerequisite to other one. This series is planned with the aim of forming a system that is built on each other and nurturing each other.

Ö Z Y E Ğ İ N U N I V E R S I T Y F A C U L T Y O F A R C H I T E C T U R E A N D D E S I G N D E P A R T M E N T O F A R C H I T E C T U R E D E S I G N S T U D I O S

		CDF OBJECTIVES	CDF CONTENT	LEARNING OUTCOMES
MİM 101 / ARCH 101	TASARIM / DESIGN	This course aims to introduce to the students the basic elements and principles of design and help them develop design skills via 2-dimensional and 3-dimensional design assignments.	Topics include the basic elements and principles of design, the formal and artistic items closely related to architecture, analysis and abstraction of objects and compositions, visual perception in composition, spatial and formal compositions.	<ol style="list-style-type: none">1. Explain basic elements and principles of design.2. Implement design processes through the stages of observation, analysis and organization.3. Present the design in two or three dimensional representation tools.
MİM 102 / ARCH 102	MİMARİ TASARIM STÜDYOSU I / ARCHITECTURAL DESIGN STUDIO I	This course aims to guide the students in designing a small-scale space or a building using the basic principles and processes of architectural design.	The course covers the concepts of anthropometry; the development of a concept for the design of a small-scale space or a building; functional, structural and environmental parameters required to solve a design problem; and the presentation of a design project through various architectural representation tools.	<ol style="list-style-type: none">1. To develop a concept for the design of a small-scale space or a building.2. To apply architectural concepts to architectural design as an architectural strategy.3. To use functional, structural and environmental parameters in solving architectural design problems.4. To use various architectural representation tools.
MİM 201 / ARCH 201	MİMARİ TASARIM STÜDYOSU II / ARCHITECTURAL DESIGN STUDIO II	The course aims the students to understand and internalize the basic principles of architectural design and to develop small and medium sized designs.	Within the scope of this course, small and medium-sized architectural designs are developed depending on the place and function; form and structure features are examined and designs are presented with various architectural representation tools.	<ol style="list-style-type: none">1. Explain the universal and local, social and cultural context in which architectural design related.2. Interpret the datas in the design process through creative thinking.3. Develop a medium-scale architectural design with the information obtained during the design process.4. Design by using knowledge about natural and built environment and using various tools.

MİM 202 / ARCH 202	MİMARI TASARIM STÜDYOSU III / ARCHITECTURAL DESIGN STUDIO III	The course aims the students to design a new building within an existing and/or historic environment.	Within the scope of this course, the existing pattern in which the design will be realized is examined through various analysis methods and representation techniques and thus the information generated from the context is transferred to architectural design.	<ol style="list-style-type: none"> 1. Analyze the social, cultural and physical characteristics of the urban fabric. 2. Interpret the urban reading findings in a way that coincides with the identity of the current environment. 3. Develop design alternatives that take environmental values into account within an existing urban fabric. 4. Use the appropriate representation tools from the analysis stage to the project.
MİM 301 / ARCH 301	MİMARI TASARIM STÜDYOSU IV / ARCHITECTURAL DESIGN STUDIO IV	The objective of this course is to define new criteria and tools for developing new solutions to contemporary architectural issues and producing creative designs.	This course discusses the development of basic architectural principles given in previous design studios; with design processes and building systems knowledge and skills. Students conduct research and explorations on material and structural system analysis through a problem centered on identity and culture in architecture.	<ol style="list-style-type: none"> 1. Develop concepts for design. 2. Apply the architectural concepts to the projects as design strategy. 3. Analyze the environment through the concept of 'place'. 4. Apply functional, structural, and environmental parameters into architectural projects.
MİM 302 / ARCH 302	MİMARI TASARIM STÜDYOSU V / ARCHITECTURAL DESIGN STUDIO V	This course aims to introduce the student to apply integrated design approach while dealing with complex spatial problems by involving the building sub systems and architectural details.	This course focuses on the design of a building complex in detail. On one hand, spatial organisation of a building is studied while on the other hand, suitable solutions are sought to the interface problem of building and environment using passive and active systems. Solutions are developed until construction Project stage by involving research related to construction materials, structural system and building service systems in design process.	<ol style="list-style-type: none"> 1. Develop a complex building design with integrated design approach. 2. Apply the decisions on construction materials and building production systems to design. 3. Solve the construction details within the scope of efficiency, sustainability, health and comfort. 4. Apply the decisions on building sub-systems, such as structural system and building service systems as integrated with the architectural design.
MİM 401 / ARCH 401	MİMARI TASARIM STÜDYOSU VI // ARCHITECTURAL DESIGN STUDIO VI	The main objectives of this course are to provide students an insight into the importance of the public space, to help them interpret research findings and produce coherent design alternatives.	This design studio focuses on urban scale spatial problems and solutions. In this context; the student interprets the data of the public space; produces alternative solutions for the problematic points of the city by using different functions and spatial sequences.	<ol style="list-style-type: none"> 1. Analyze urban and public space. 2. Evaluate urban fabric. 3. Interpret research findings on urban design. 4. Create integrated design solutions using conventional and contemporary design and representation tools.
MİM 402 / ARCH 402	MEZUNİYET PROJESİ / CAPSTONE (GRADUATION) PROJECT	This course aims the student who is an architect candidate, to develop an independent architectural design project using the knowledge and experience acquired throughout the undergraduate education.	This course covers the solution of a complex architectural design problem, the development and presentation of an environmentally friendly and integrated design solution, with the knowledge and experience acquired during architectural education.	<ol style="list-style-type: none"> 1. To demonstrate the process of data analysis and evaluation required for a novel architectural design project. 2. To develop an integrated building design for a complex design problem. 3. To apply the theoretical and practical knowledge into design acquired throughout undergraduate education. 4. To integrate professional ethics, legal responsibilities and regulations that an architect should fulfill into the design process. 5. To use conventional and contemporary graphic, written, visual and digital architectural representations tools competently.

Studio Execution / Operation / Announcement / Interaction / Partnerships / Integration:

1. The studios are carried out within the framework of "Özü MTF Architecture Studio Culture" documents.
2. The studio has full-time and part-time teaching members / instructors / research assistants assigned by the Department and the Dean's Office.
3. The number of students per faculty member (+ research assistant) will be between 15-20
4. Studio alternative modes of execution:
 - a) A faculty member / student group,
 - b) Several faculty members / learner groups come together horizontally or vertically to make horizontal or vertical joint studios,

- c) Multiple faculty members / number of faculty members x 15-20 student groups (eg 3 faculty members x 15-20 students 45-60 students)
- 5. Announcements about the studios are made by syllabies on SIS and LMS, and on the blog before each semester registration week with posters. Each studio tutor shares information on this posters info about tutor / s' names, subject, location, method, rules, attendance, participation, technical trip etc. in a one page file.
- 6. Students register the sections of studios on the SIS with their own preferences. They can change sections during the add - drop period. If there is a vacancy in the same semester, the quota of the other sections will not increase.
- 7. It is expected that the works done in studios in the same or different semesters will be made to interact with activities such as jury, open jury, exhibition, seminar, colloquium at certain intervals,
- 8. Establishment of partnerships for horizontal and vertical integration of studios is encouraged.

Studio Environment:

It is possible to acquire the knowledge, skills and competencies necessary for solving architectural design problems from simple to the most complicated with general design problems by providing studio environments with information resources, technology and equipments.

The studio environment is expected to provide the following possibilities:

1. Each studio student has a study unit
2. Flexible space that allows individual and team work,
3. Projector, display, pin-up, model making facilities,
4. Infrastructure for material recycling,
5. First aid infrastructure,
6. Internet access,
7. 7/24 operation possibility
8. The application of the cleanliness rules of each student,
9. Compliance with the general cleaning and use rules,
10. Use of time: Architectural design education is a type of teaching-learning that requires time and continuity. For this reason, the studio tutors and students should be able to evaluate the studio time in the most efficient way and ensure that the high participation and sharing studio is an active - interactive learning environment.
11. The main focus of design education is the studio environment. In addition, non-studio events (technical trips, fieldwork, library research, field research, exhibitions, case studies, resource reviews, student competitions and participation in workshops) should be encouraged.
12. Part-time faculty members, invited speakers and jury members working in design and construction practices should be supported to participated in the design studios.

Assessment / Transparency / Informing Public / Ethics issues in the Studio:

1. Fair and transparent evaluation,
2. An interim evaluation before course withdrawal period and announcement to the students
3. Preliminary jury, final jury, class juries and table-top criticism are the key to protecting personalities with mutual respect and goodwill
4. Announcement of the student activities to the public through exhibition, publication etc.
5. Student and the instructor are required to behave very carefully about plagiarism, overdued help and other similar ethical issues
6. In the case of any work done (exam, jury, sketch exam, pre-submission, interim submission etc.), the studio executives should behave in the same way to the students in the same class and group without discrimination,

Studio Culture Review and Revision

The studio culture document is assessed every three years with the cooperation of the Dean of the Faculty of Architecture and Design, the Department of Architecture, the Academic Board of the Architecture Department, the student study group, alumni and advisory committee. It is revised when it is deemed necessary by the Architecture Department Board.

11. Internship

There are 3 compulsory internships in the undergraduate programs of Department of Architecture.

Architecture (English) Undergraduate Program
ARCH 200 Summer Internship I (Research) 2 ECTS
ARCH 300 Summer Internship II (Office) 2 ECTS
ARCH 400 Summer Internship III (Construction Site) 4 ECTS

Architecture (Turkish) Undergraduate Program
MİM 200 Yaz Stajı I (Araştırma) 2 ECTS
MİM 300 Yaz Stajı II (Büro) 2 ECTS
MİM 400 Yaz Stajı III (Şantiye) 4 ECTS

Internship URL:

<https://www.ozyegin.edu.tr/en/architecture/undergraduate-barch/internship>

Internship Information Form:

[https://www.ozyegin.edu.tr/imgken/getattachment/AKADEMIK-PROGRAMLAR/mimarlik-ve-tasarim-fakultesi/architecture/B-Arch/Internship/FAD_Mandatory_Internship_Information_Form-\(Annex-1\).pdf](https://www.ozyegin.edu.tr/imgken/getattachment/AKADEMIK-PROGRAMLAR/mimarlik-ve-tasarim-fakultesi/architecture/B-Arch/Internship/FAD_Mandatory_Internship_Information_Form-(Annex-1).pdf)

Internship Diary Notebook

The internship Diary Notebook is consist of a cover page, a report page, and diary pages for every day of internship. Please find the templates of these page in the following link:

<https://www.ozyegin.edu.tr/en/architecture/undergraduate-barch/internship>

Intern Evaluation Form:

[https://www.ozyegin.edu.tr/imgken/getattachment/AKADEMIK-PROGRAMLAR/mimarlik-ve-tasarim-fakultesi/architecture/B-Arch/Internship/FAD-ARCH-INTERN-EVALUATION-FORM-\(Annex-2\).pdf](https://www.ozyegin.edu.tr/imgken/getattachment/AKADEMIK-PROGRAMLAR/mimarlik-ve-tasarim-fakultesi/architecture/B-Arch/Internship/FAD-ARCH-INTERN-EVALUATION-FORM-(Annex-2).pdf)

Internship Committee of Department of Architecture:

ARCH 200: Dr. Ebru Karahan

MİM 200: Dr. Semra Tokay

ARCH 300: Dr. Mehmet Saner

MİM 300: Dr. Tayfun Gürkaş

ARCH 400 / MİM 400: Dr. Neşe Ganiç Sağlam, Ece Kalaycıoğlu Özdemir, Prof. Dr. Orhan Hacıhasanoğlu

12. Information about Academic Building 4

The new building of Özyeğin University Faculty of Architecture and Design, whose project design studies started in 2013, opens its doors to students and academicians in the spring semester of 2019-2020 academic year. The work carried out with our Princeton design partner ARK-itecture has been completed as of the new period and the official opening of the AB4 Building had been realized in February 10th 2020.

Faculty of Architecture and Design building (AB4) is the last stage of Özyeğin University Çekmeköy Campus project, which has been running by ARK-itecture and B-Design since 2013. Designed with the aim of establishing a strong bond both physically and functionally with the rest of the campus, the structure includes the spatial requirements of architectural education such as open studios, jury and exhibition areas, amphitheater classrooms, as well as laboratories to be used by students of ÖZÜ Engineering Faculty.

In AB4, where all the departments of the Faculty of Architecture and Design will take place, there are studio spaces with a capacity of 1,400 students, 26 classrooms, 9 students and research laboratories, and a model - digital model - design-do (wood-metal) and ceramic workshops.

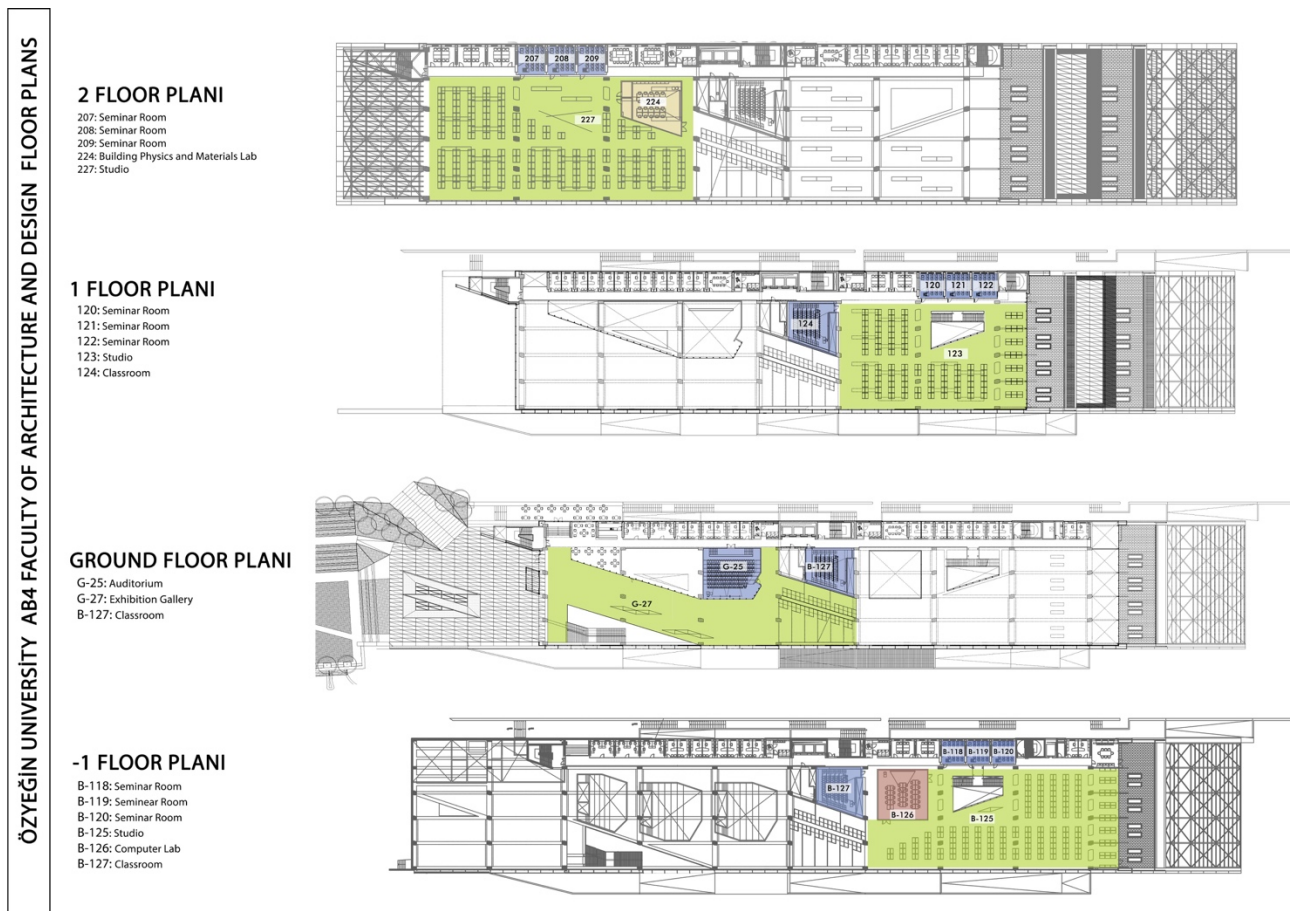

The building, which demonstrates its innovative approach both indoors and outdoors, is designed to capture the diagonal connection it has established with the main square of the campus, both in facade character and in the interior between different levels and functions. The

building, which is considered as a completely creative expression area, offers studios and collaboration areas designed as open lofts, and offers a completely transparent contemporary learning environment by keeping the visual contact among students at the highest level. AB4 also enables new interactions in the landscape-building-human triangle.

The diagonal form, which dominates the overall design of the building, takes its exit from the diagonal connection established by the faculty structure with the main square of the campus. The geometry with this triangular form is manifested in all interior elements, especially the facade, the relationship between the plan organization and different levels and functions. Especially the design of the western facade ensures the continuity of this character, and also responds to the need for controlled light in the studio areas. The building, whose facade is enriched with natural-looking and textured material, also displays a harmonious relationship with the forest landscape that it is located opposite.

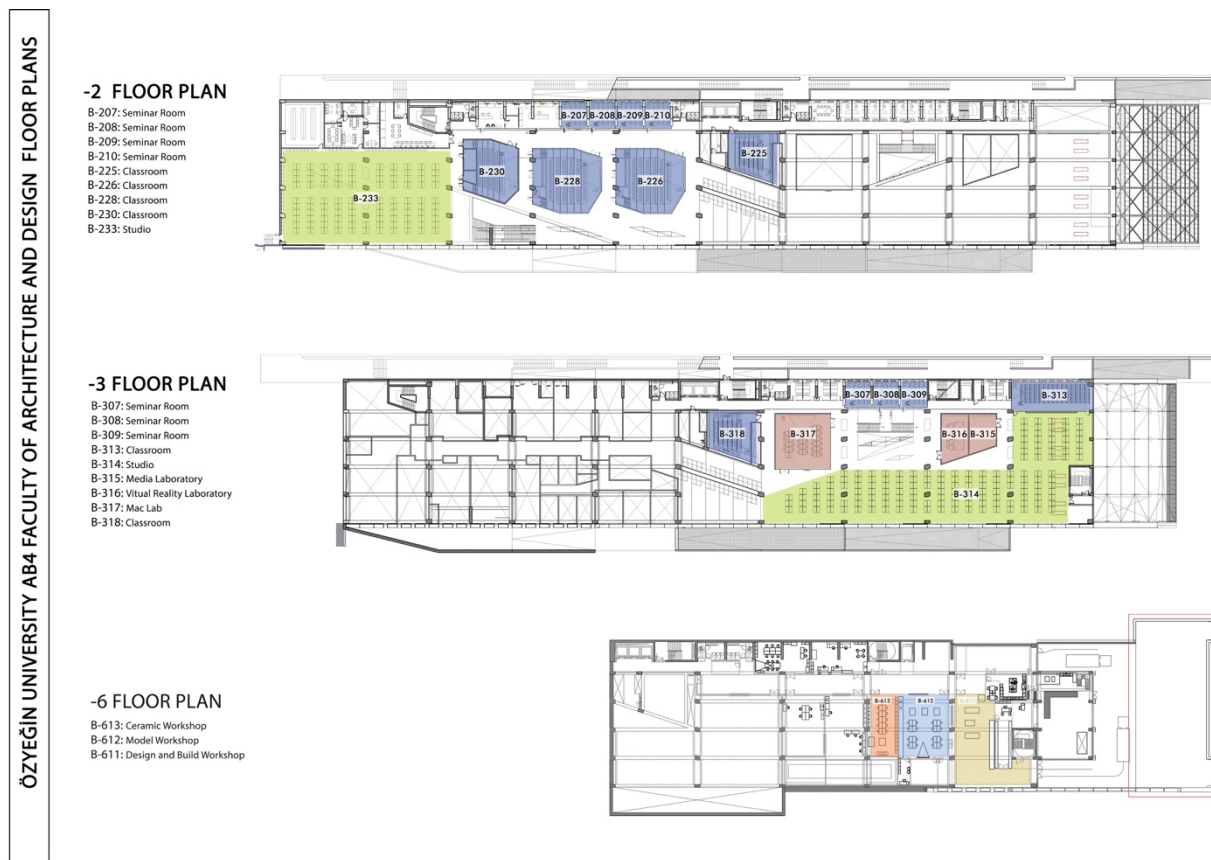

An educational structure for our students with the physical opportunities it offers. It is aimed that the students of the Faculty of Architecture and Design can observe and experience the layers that make up a structure with the exposed structural elements such as precast floors, columns, mechanical and technical details in the building.

In AB4, where the project is intended to be an educational structure with both its conceptual language and the physical facilities it offers, it is aimed to raise individuals who master the basic principles of architecture by creating a design in which human-building-landscape interaction can be observed and tried. While the transparency of the design and the ability to read the building layers offer an unusual experience in educational buildings, it introduces its users to contemporary architectural techniques.

